

pu07 suj

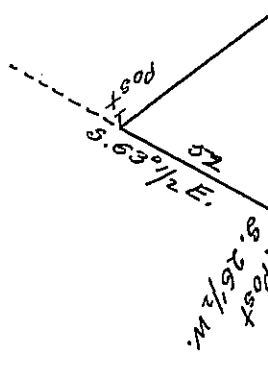

✓

Somerset -

James M^e Mullin

179²/₂ ac alle

Ret^d 22^d April 1815.

There is already a tract of land patented under the Warrant on which this survey was made, but that tract was patented by mistake and ought to have been patented on a Warr^t in the name of James M^e Mullin dated 29th Jan^y 1770

No 48 Bedford

Accep^d 1st April 1813,

A Dra
County
Cent for
pursuan
the twen

To Joh
Sur

N. B.

IN TEST